

CITY OF MERCED
Engineering Department

TO: Bicycle Advisory Commission
FROM: John C. Sagin, Jr. AIA – Principal Architect
DATE: October 27, 2015
SUBJECT: ATP Grant – Multi-use Path Project (BNSF Railroad and Highway 59)

ACTION REQUIRED:

Information item and opportunity to comment.

BACKGROUND

The City has received a grant for the installing a multi-use path crossing of BNSF Railroad between Olive Avenue and Cooper Avenue on Highway 59. Work will include the widening of the travel lane to accommodate the pathway, shoulder work, new crosswalks, and striping.

DISCUSSION

The City has already applied for an Encroachment Permit from Caltrans and has submitted a Preliminary Environmental Study (PES) form which has been forwarded to Caltrans Environmental Division. The PA&ED (Project Approval and Environmental Document) phase should be allocated at the August CTC (California Transportation Commission) meeting next week with the federal authorization to follow, but Caltrans Environmental Division needs to start work now on the PES in order to notify the City of the environmental requirements. Once CEQA/NEPA have been obtained, the City of Merced will request an allocation/authorization for the PS&E (Plans, Specifications, and Estimate) phase.

ACTION

The BAC is invited to review and comment.

Attachment

1. Site Plan

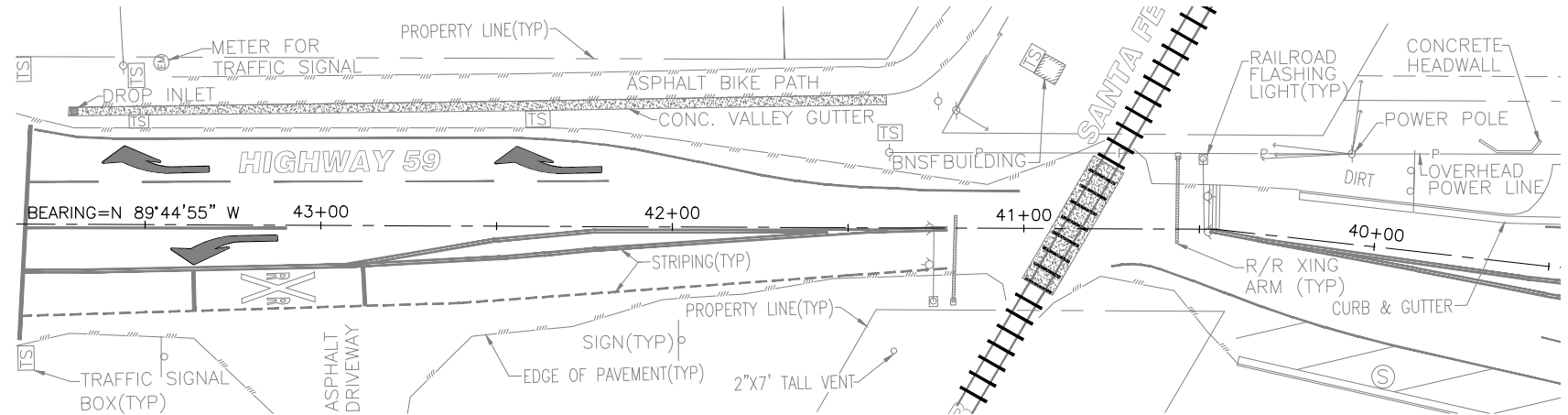

EXISTING PLAN

SCALE: 1"=50'

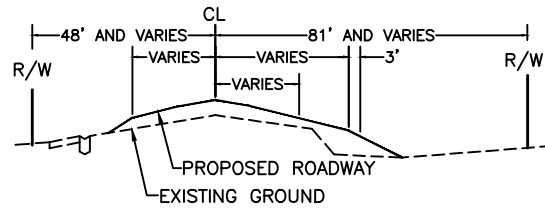

TYPICAL X SECTION

SCALE: NTS

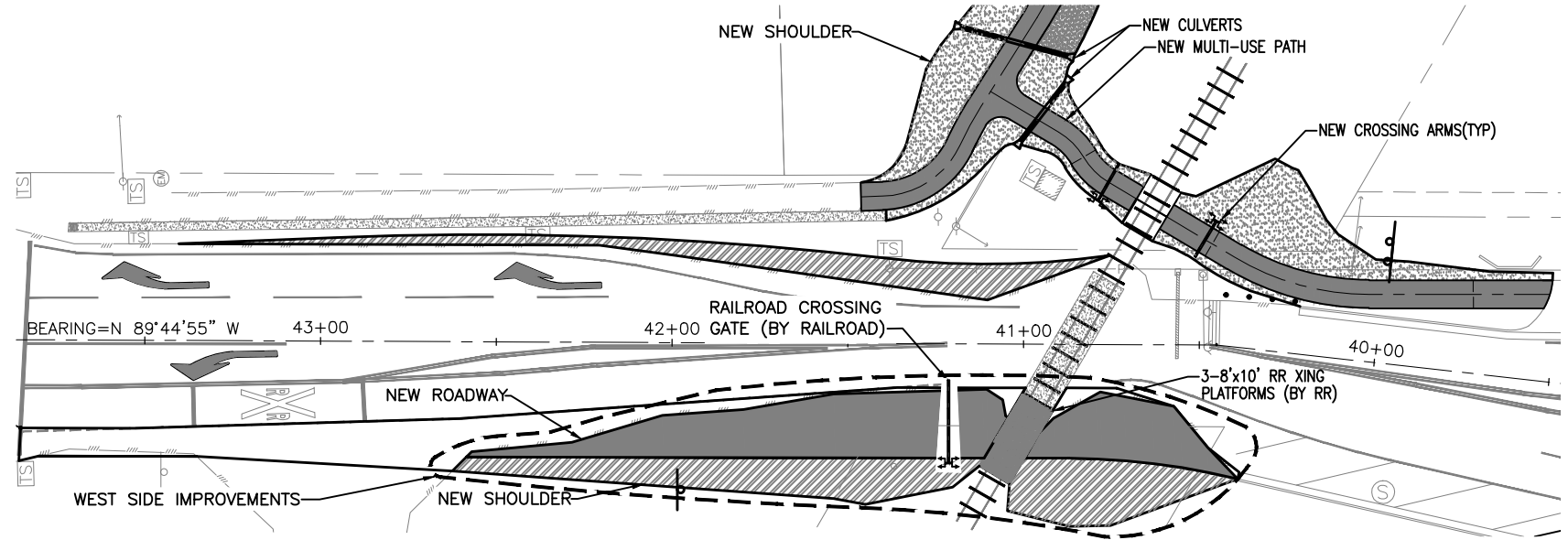

PROPOSED PLAN

SCALE: 1"=50'

ENGINEERING DEPARTMENT

CITY OF MERCED, CA.

EXHIBIT FOR ROADWAY CONSTRUCTION ON WEST SIDE OF HWY 59

SHEET 1 OF

DRAWN: JDS

APPROVED BY:

DATE

PROJECT NO: 0598 CONSTRUCT SR-59 MULTI-USE PATH CROSSING OF BNSF

DATE: 1/12/15

1/12/15

LOCATION: SR-59 AT POST MILE 16.01 IN MERCED DISTRICT 10

DWG.: 1

CITY ENGINEER

SCALE.: 1" = 50'

1